

The choke decouples the bus line from the power supply. It can be used together with the power supply unit SV/S 30.640.5 to supply a second EIB line.

The choke has a reset push button for freeing up the bus line and resetting the connected bus devices.

All connections are made via bus connection terminal.

Technical Data

Power supply	– via EIB	
Input/output	– Rated voltage	30 V DC
	– Rated current	640 mA
	– max. voltage drop (at 640 mA)	1 V
	– max. power loss (at 640 mA)	1 W
Operating and display elements	– red LED	Reset, Operation
	– Switch	Reset
Connection	– Input	Connection terminal (yellow/grey)
	– Output	Bus connection terminal (black/red)
Type of protection	– IP 20, EN 60 529	
Ambient temperature range	– Operation	– 5 °C ... 45 °C
	– Storage	– 25 °C ... 55 °C
	– Transport	– 25 °C ... 70 °C
Design	– modular installation device, proM	
Housing, colour	– Plastic housing, grey	
Mounting	– on 35 mm mounting rail, DIN EN 50022	
Dimensions	– 90 x 36 x 64 mm (H x W x D)	
Mounting depth/width	– 68 mm/2 modules at 18 mm	
Weight	– 0.1 kg	
Certification	– EIB and KNX certified	
CE norm	– in accordance with the EMC guideline and the low voltage guideline	

Wiring diagram

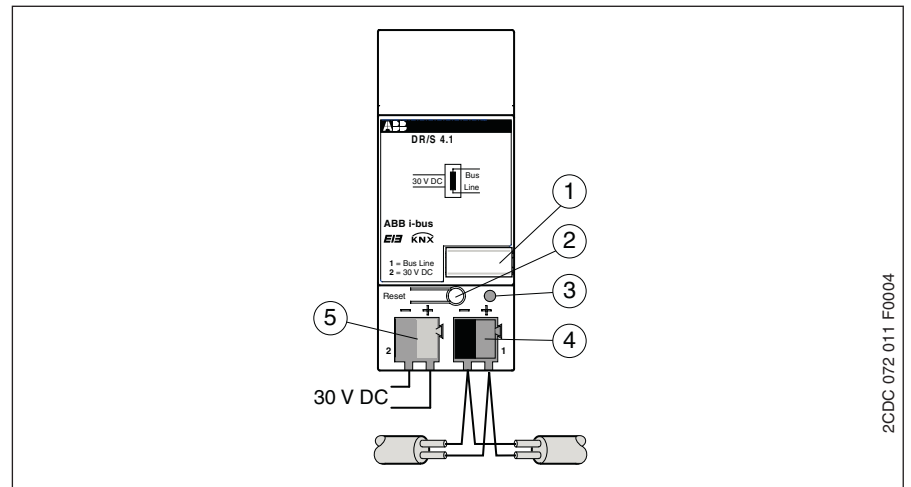

2CDC 072 011 F0004

- 1 Label carrier
- 2 Reset push button
- 3 Reset LED
- 4 Bus connection terminal
- 5 Connection terminal 30 V DC

Note

For a “reset”, push the reset push button. A reset lasts for 20 seconds regardless of the duration of the push button action.

If the line should be disconnected for a longer period, the bus connection terminal must be removed from the power supply.

Wiring diagram in connection with Line Coupler LK/S 3.1

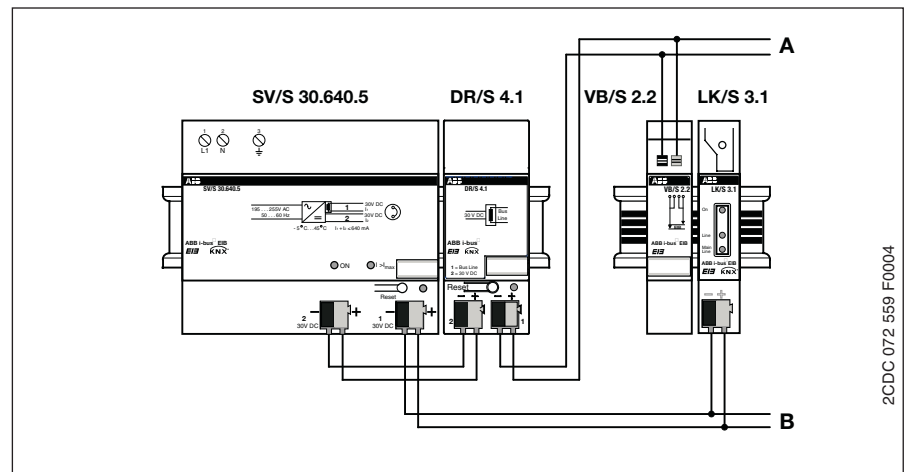

2CDC 072 559 F0004

Wiring diagram in connection with Line Coupler LK/S 4.1

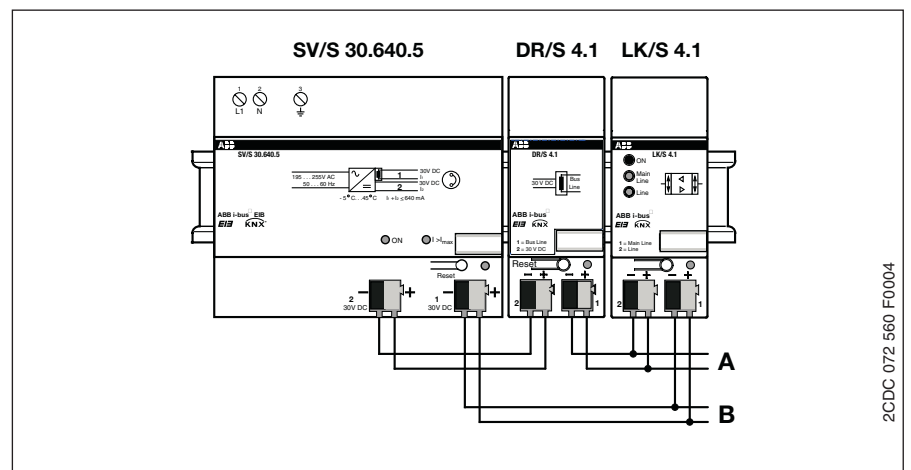

2CDC 072 560 F0004